

PLAT OF SURVEY

OF



LOT 15 AND THE SOUTH 5 FEET OF LOT 14 IN BLOCK 1 IN RESUBDIVISION OF KREEN AND DATO'S OAKTON "L" PARKVIEW SUBDIVISION IN THE NORTHWEST 1/4 OF THE NORTHEAST 1/4 OF THE NORTHWEST 1/4 OF SECTION 27, TOWNSHIP 41 NORTH, RANGE 13 EAST OF THE THIRD PRINCIPAL MERIDIAN, IN COOK COUNTY, ILLINOIS.

TOTAL LAND AREA = 4,917 sq. ft.

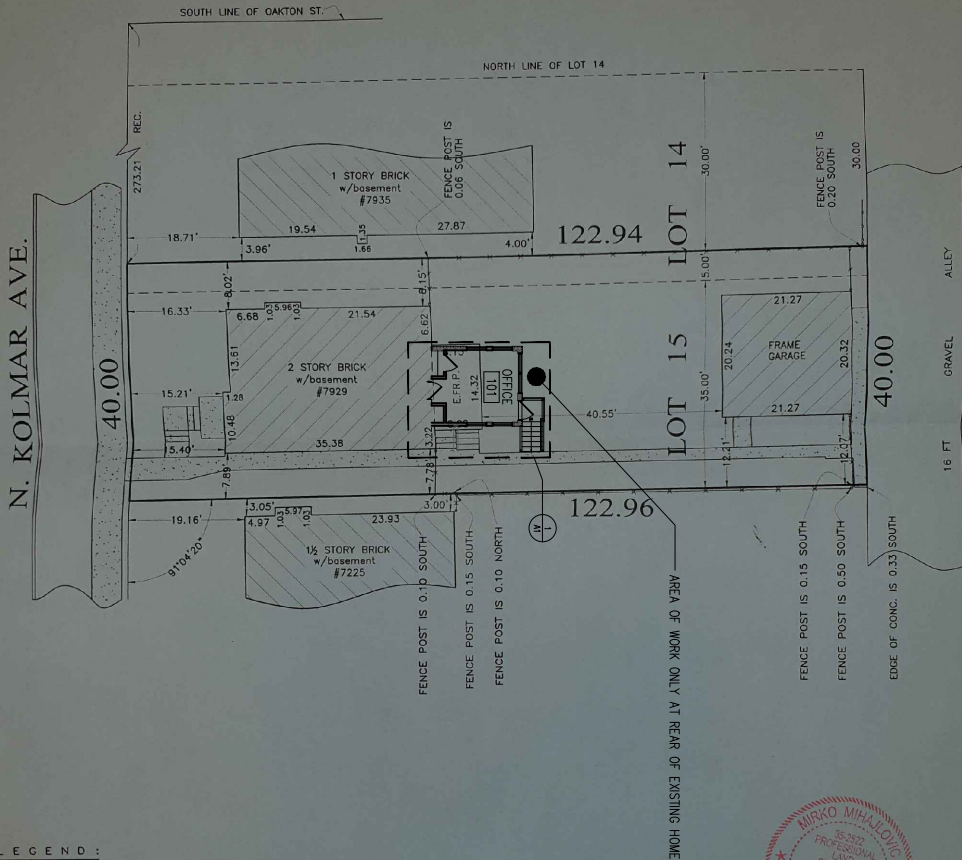

LEGEND :

- CHAIN LINK FENCE
- WOOD FENCE
- CONCRETE PAVEMENT
- ENCLOSED FRAME PORCH
- OPEN FRAME PORCH
- OPEN BRICK PORCH
- OPEN CONC. PORCH
- EDGE OF CONCRETE

THIS PROFESSIONAL SERVICE CONFORMS TO THE CURRENT ILLINOIS MINIMUM STANDARDS FOR A BOUNDARY SURVEY.

FOR BUILDING LINES, EASEMENTS AND OTHER RESTRICTIONS NOT SHOWN HEREON, REFER TO YOUR DEED, TITLE POLICY AND LOCAL ZONING ORDINANCE, ETC.

LEGAL DESCRIPTION NOTED ON THIS PLAT WAS PROVIDED BY THE CLIENT AND MUST BE COMPARED WITH DEED AND/OR TITLE POLICY. ALL DIMENSIONS ARE SHOWN IN FEET AND DECIMAL PARTS THEREOF. NO CORNERS WERE MONUMENTED PER CUSTOMER REQUEST.

State of Illinois
County of Cook

We, M M Surveying Co., Inc., do hereby certify that we have surveyed the above described property and that the plat hereon drawn is a correct representation of said survey.



Signature: *M. Mihalovic*

Date: 05-30-2006

REG. ILL. Land Surveyor No. 35-252-2
LIC. EXP. NOVEMBER 30, 2006

ORDER NO. 69934
SCALE: 1 INCH = 16 FEET
FIELDWORK COMPLETION DATE: MAY 24, 2006
ORDERED BY: MORGAN & PERL

